

**TDS5000B Series**  
**050-3708-00**  
**SATA Hard Disk Drive Replacement Kit**  
**Instructions**

[www.tektronix.com](http://www.tektronix.com)



075-0991-00

**Tektronix**

Copyright © Tektronix. All rights reserved. Licensed software products are owned by Tektronix or its subsidiaries or suppliers, and are protected by national copyright laws and international treaty provisions.

Tektronix products are covered by U.S. and foreign patents, issued and pending. Information in this publication supersedes that in all previously published material. Specifications and price change privileges reserved.

TEKTRONIX and TEK are registered trademarks of Tektronix, Inc.

## **Contacting Tektronix**

Tektronix, Inc.  
14200 SW Karl Braun Drive  
P.O. Box 500  
Beaverton, OR 97077  
USA

For product information, sales, service, and technical support:

- In North America, call 1-800-833-9200.
- Worldwide, visit [www.tektronix.com](http://www.tektronix.com) to find contacts in your area.

---

# Table of Contents

Service Safety Summary.....	1
Kit Description.....	2
Products.....	2
Kit Parts List .....	2
Installation Instructions .....	3
Preparation.....	3
Remove the External Modules .....	3
Install the SATA Hard Disk Drive .....	5



---

# Service Safety Summary

Only qualified personnel should perform service procedures. Read the *Service Safety Summary* and the *General Safety Summary* located in the service manual before performing any service procedures.

**Do Not Service Alone.** Do not perform internal service or adjustments of this product unless another person capable of rendering first aid and resuscitation is present.

**Disconnect Power.** To avoid electric shock, switch off the instrument power, then disconnect the power cord from the mains power.

**Use Care When Servicing With Power On.** Dangerous voltages or currents may exist in this product. Disconnect power, remove battery (if applicable), and disconnect test leads before removing protective panels, soldering, or replacing components.

To avoid electric shock, do not touch exposed connections.

## Kit Description

This kit describes the installation of the SATA Hard Disk Drive in a TDS5000B Series Oscilloscope.

## Products

**TDS5034B. SN B062881 and Below**

**TDS5054B. SN B065251 and Below**

**TDS5104B. SN B065251 and Below**

**TLA5201B. SN B050466 and Below**

**TLA5202B. SN B050607 and Below**

**TLA5203B. SN B050262 and Below**

**TLA5204B. SN B050485 and Below**

## Kit Parts List

<b>Quantity</b>	<b>Part number</b>	<b>Description</b>
1 ea	119-7524-XX	DISK DRIVE, HARD; 3.5 INCH, 7200 RPM, SATA II 3.0 GB/S INTERFACE, SAFETY CONTROLLED
1 ea	174-5273-XX	CABLE ASSY; HARD DISK DATA CABLE, SATA, STRAIGHT, 0.5M LONG
1 ea	174-5639-XX	CABLE ASSY MOLEX TO SATA POWER ADAPTER
1 ea	075-0991-00	INSTRUCTIONS FOR 050-3708-xx REPLACEMENT KIT

# Installation Instructions

Use the following instructions and the procedures in the TDS5000B Series Service manual (071-1362-XX) to remove the existing hard disk drive and install the SATA hard disk drive.

## Preparation

Before installing the SATA hard disk drive, follow the *Preparation* instructions in the *Removal and Installation Procedures* section of the service manual.

### Minimum Tool and Equipment List

For a list of required tools, refer to the *Removal and Installation Procedures* section in the service manual.

## Remove the External Modules

Remove the following external module parts. Refer to the *Removal and Installation Procedures* section in the service manual:

- Line Cord
- Trim
- Right Cover
- Printer Frame (if installed)

### Remove Internal Modules

---

**NOTE.** Complete the removal of the external modules before removing the following internal modules.

---

Remove the following internal modules. For removal instructions, refer to the *Procedures for Modules* in the TDS5000B Series service manual:

- Floppy Disk Drive (to allow better visibility)
- Hard Disk Drive

**PATA Hard Disk Drives.** Perform these additional tasks before installing the SATA hard disk drive.

- Disconnect the two cables from J1030 and J1040 on the PC Interface board to allow better clearance when connecting the SATA cable to the Mother board.

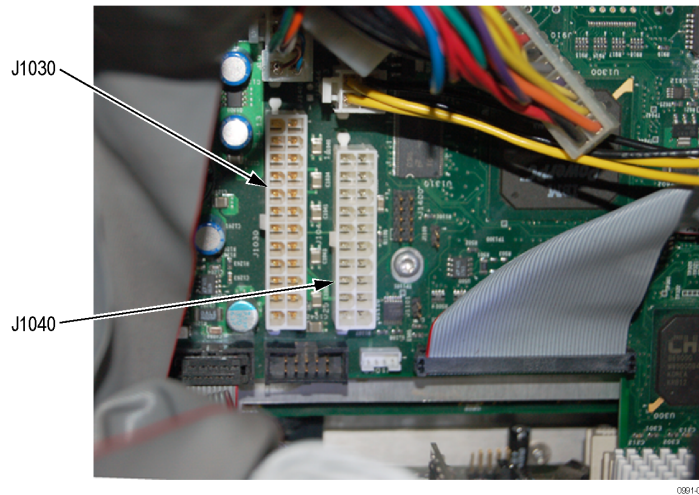

**Figure 1: Cables J1030 and J1040 locations**

- Discard the unused PATA cable.

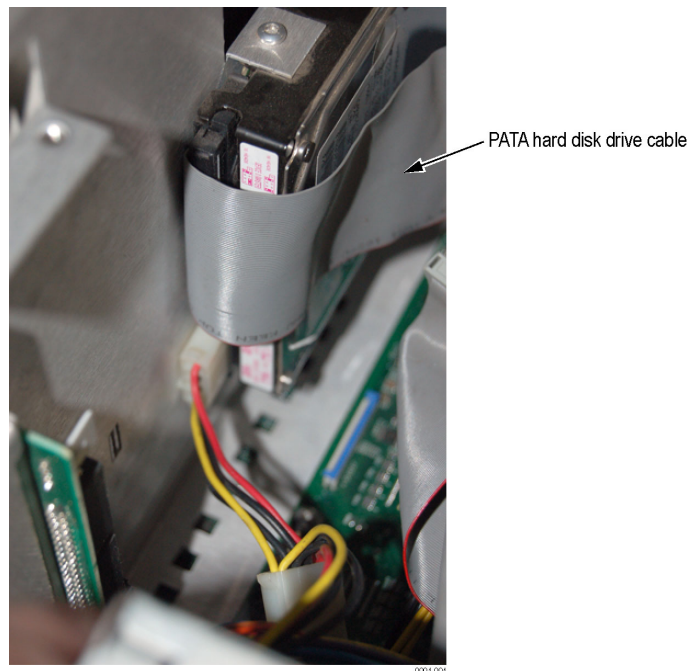
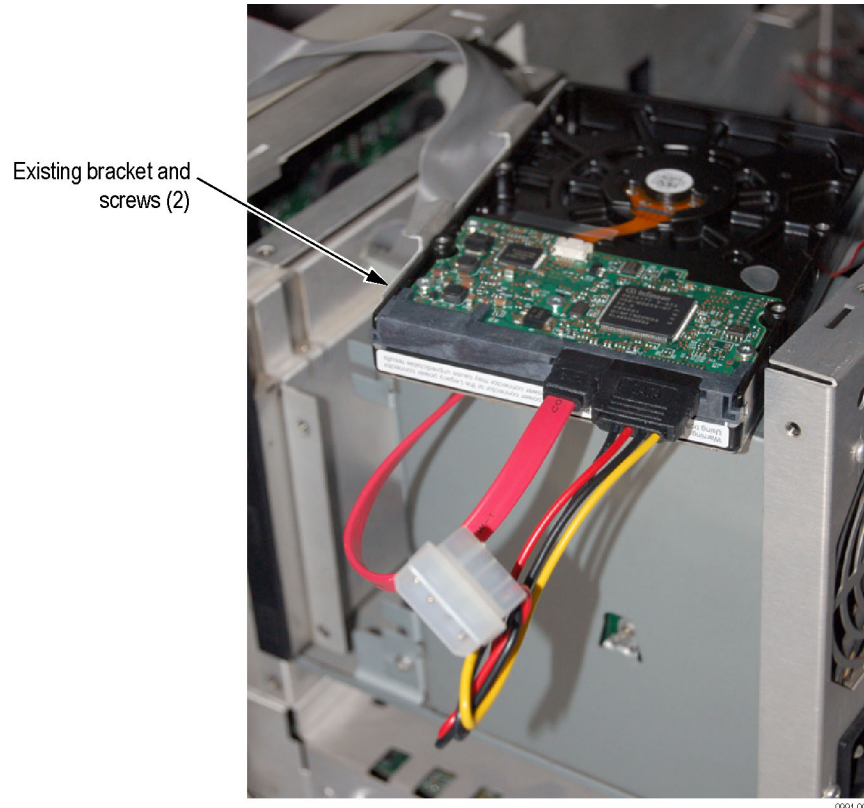

**Figure 2: PATA Hard Disk Drive**



## Install the SATA Hard Disk Drive

1. Attach the SATA Hard Disk Drive cable and Molex-to-SATA adapter cable to the connectors on the SATA Hard Disk Drive as shown.



**Figure 3: SATA hard disk drive, existing bracket, and MOLEX-to-SATA power adapter**

2. Attach the existing hard disk drive bracket to the SATA hard disk drive using the two existing T-15 TORX drive screws.
3. Connect the other ends of the two cables (See Figure 3 on page 5.):
  - Red SATA cable to the SATA Port 1 connector on the Mother board
  - Molex-to-SATA adapter cable to the P3 power cable connector

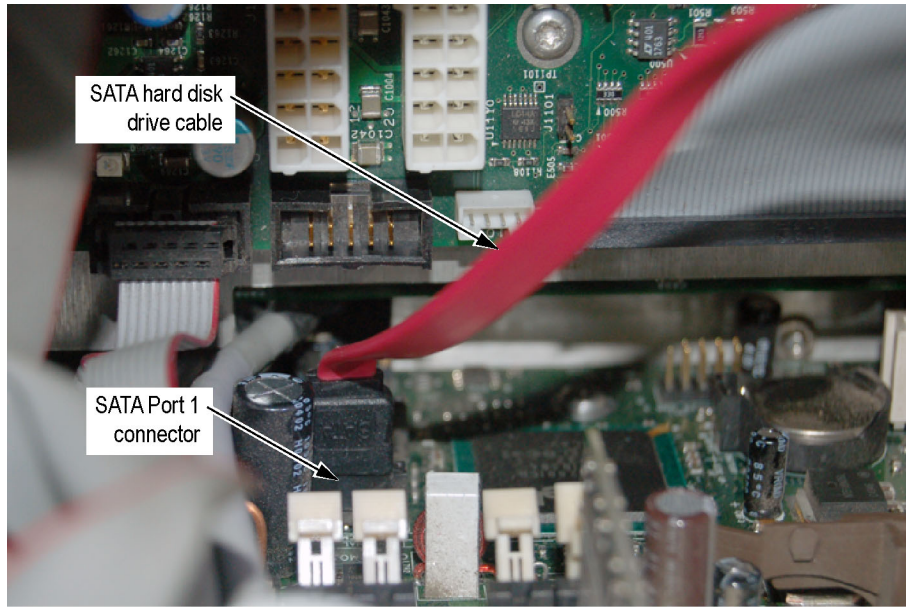

0391-004

**Figure 4: SATA cable location**

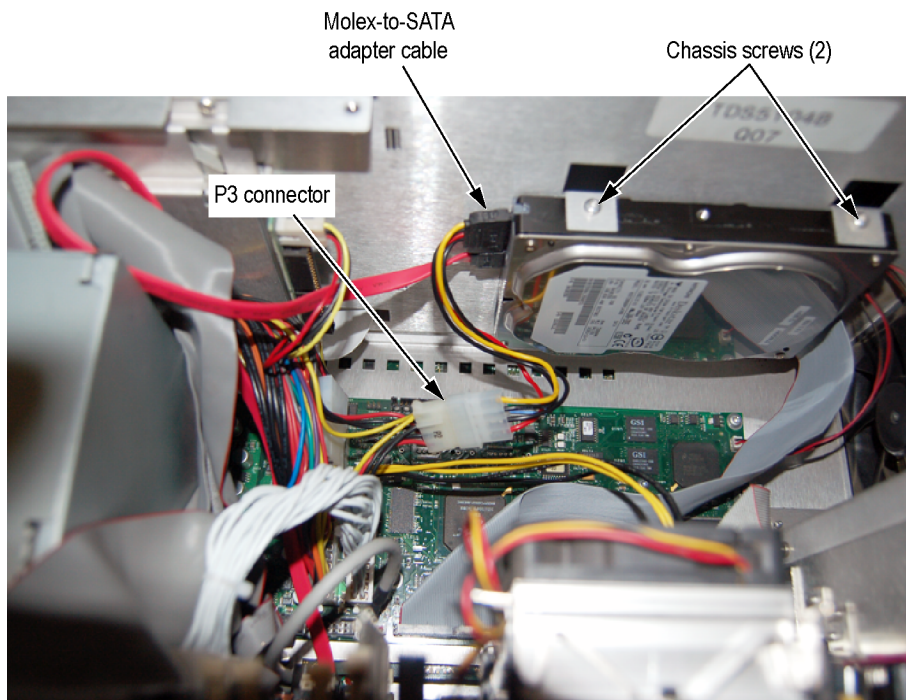

0391-005

**Figure 5: SATA hard disk drive installed**

4. Attach the hard disk drive to the chassis as shown using the two existing T-15 screws.

- PATA Hard Disk Drive Only**      Reconnect the two cables to J1030 and J1040 on the PC Interface board. (See page 4, *PATA Hard Disk Drives*.)
- Reinstall the External and Internal Modules**      Refer to the service manual to reinstall the external and internal modules that were removed.